

## Headquarters of Helvetia Patria, Saint Gall Mountains of Flowers

### Client

Helvetia Patria Versicherungen,  
Saint Gall

### Architecture

Herzog & de Meuron, Basel  
Herbaceous planting in collaboration with  
Pit Altwegg

### Work stages

All work stages  
(construction management, plantings)

### Period

2001–2004

### Area

23'000 m<sup>2</sup>

The garden consists of colourful areas characterised by a strictly composed diversity. A wide variety of plants flowering at various times create a finely balanced blend of colour that changes with the seasons.

The first highlights of the year are the spring bulbs. Until late autumn, magnificently coloured and shaped flowers and foliage, colours and leaf structures bedeck the garden, and slowly growing shrubs such as hydrangeas, juneberries, and dwarf lilacs draw clear-cut linear structures following the contours of the grounds. Along with the individual trees or groves, these copses reinforce our perception of a topography eternally in motion, in particular during

the winter months. Water-basins and organically shaped paths round off the impression.

Owing to the fragmented reflections in the windows of the new buildings, the opulence of the garden is broken up and multiplied. The character of the outside plantings oscillates between the private and the public. The small-scale features of the plantings resemble a garden, whereas the network of paths and the slightly raised topography with its groves seem more like a park.

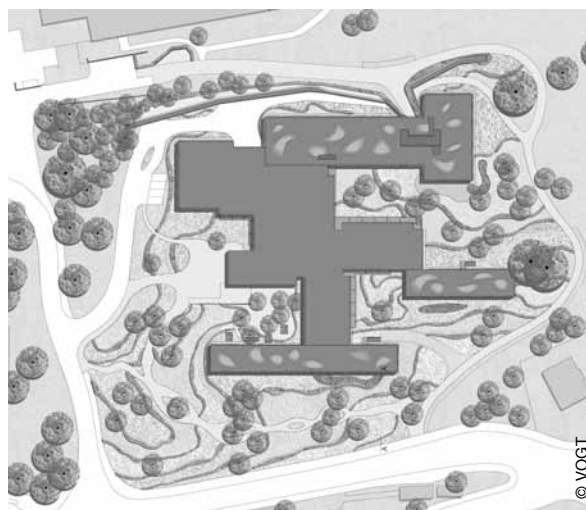

Plan view



